

ZEPHYR LINEARE

design
Carlo Colombo

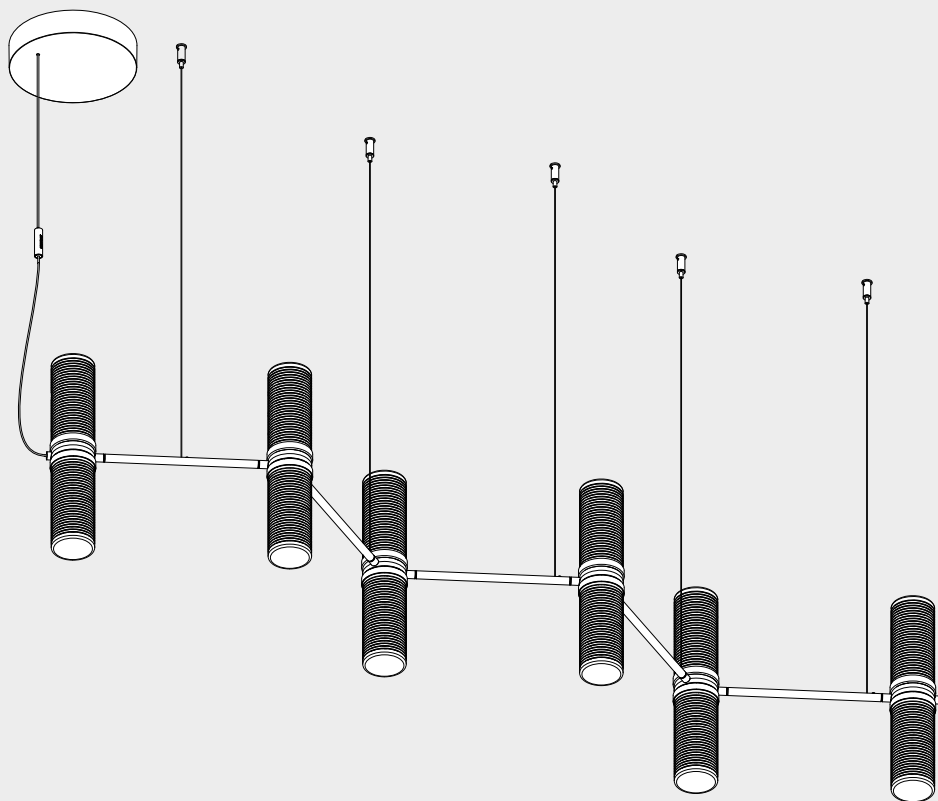



i

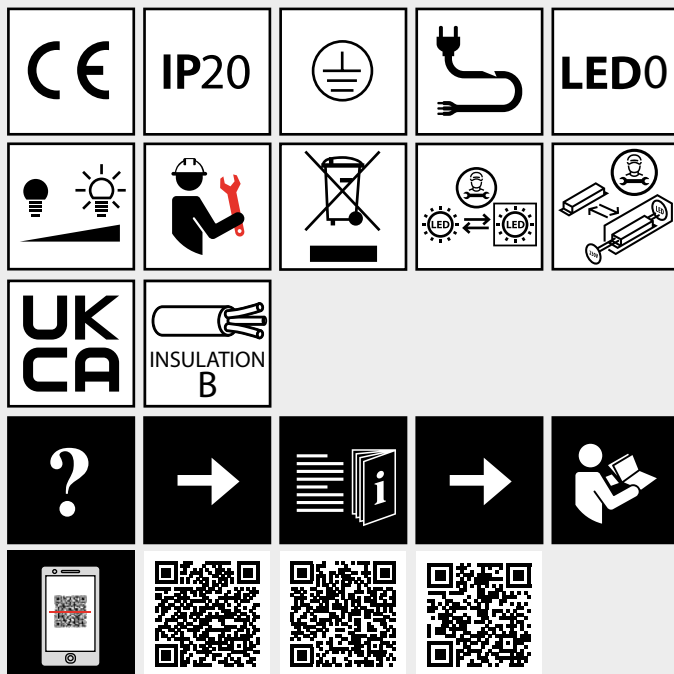

Artemide App
Quick Starting Guide



17820X0A	DALI / PUSH POWER KIT
17820X0APP	PUSH / APP POWER KIT

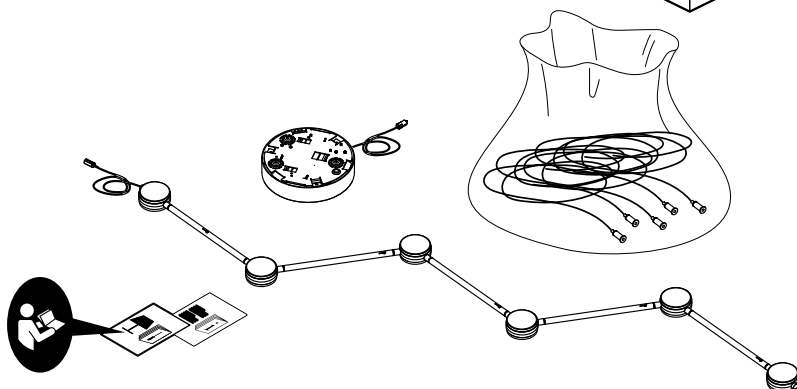
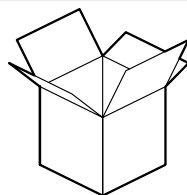

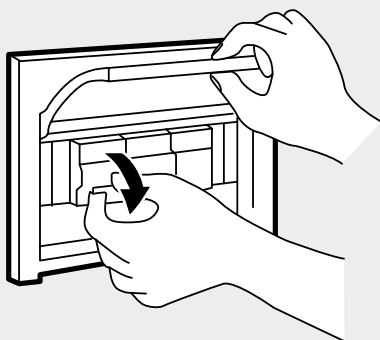
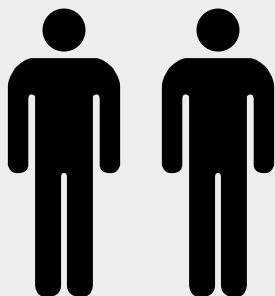
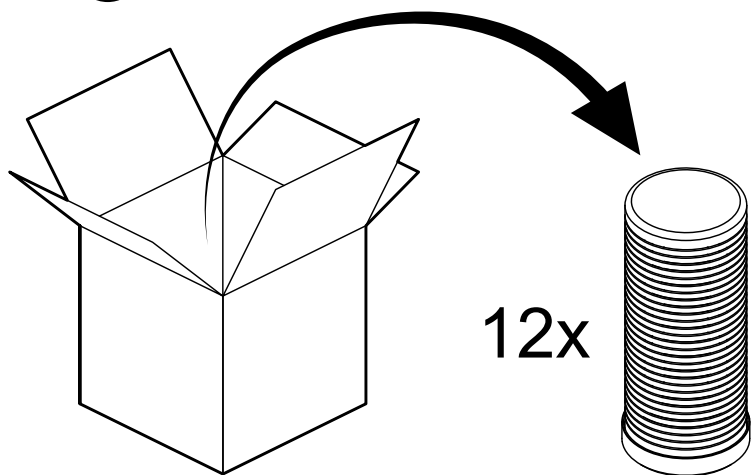
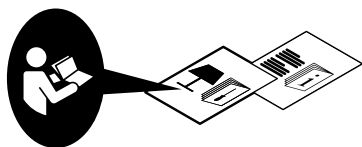

1

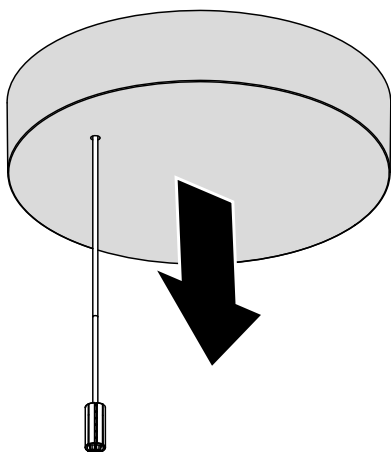

2

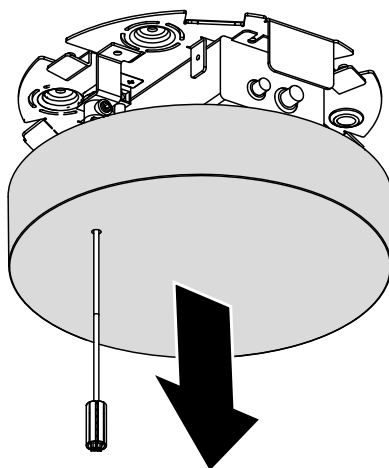

i

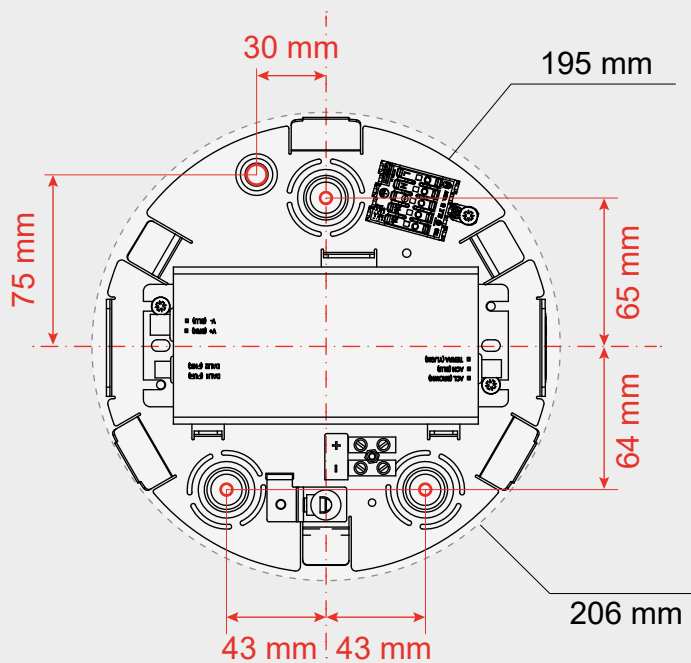

i

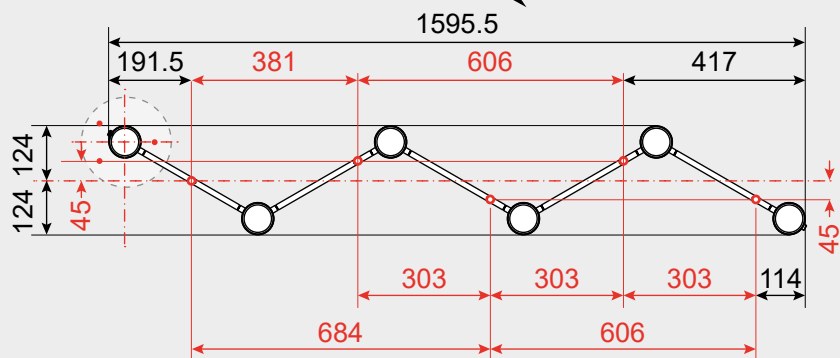
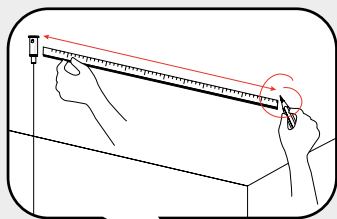

3

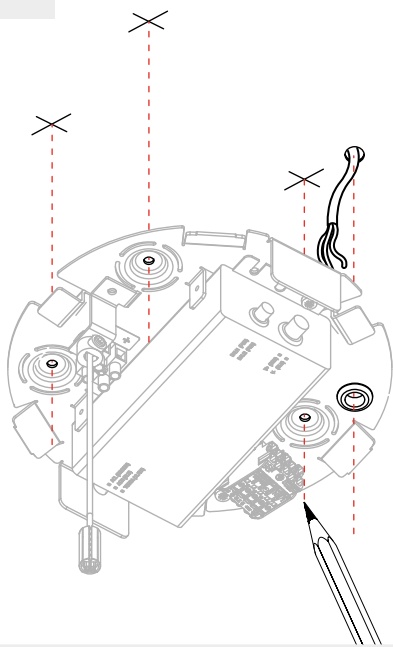

4

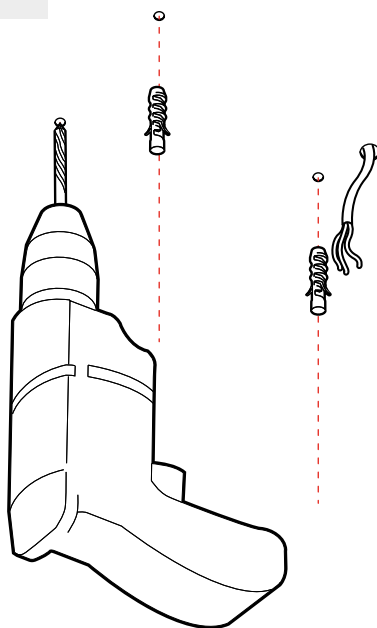

5

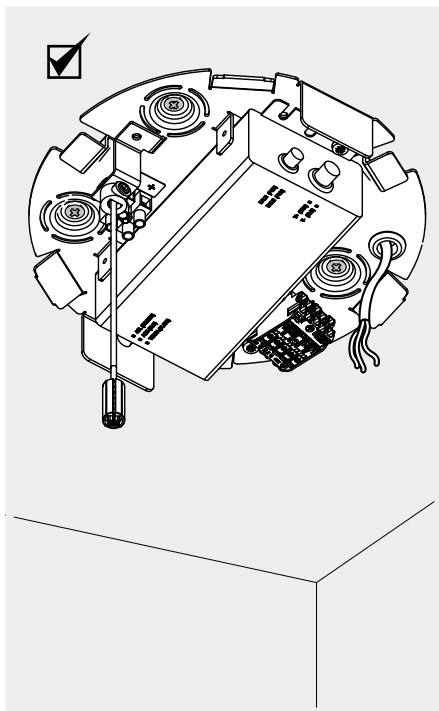
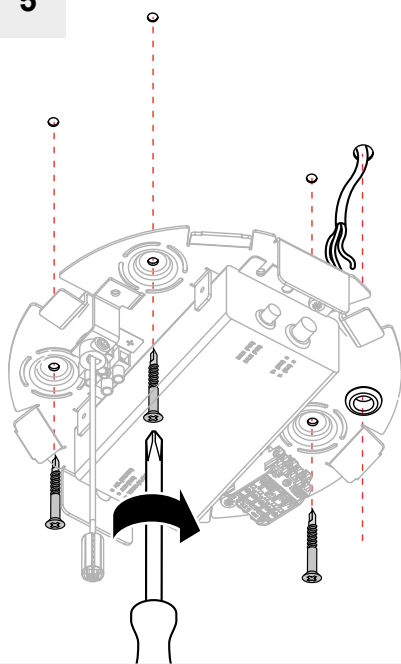

6a



17820X0A

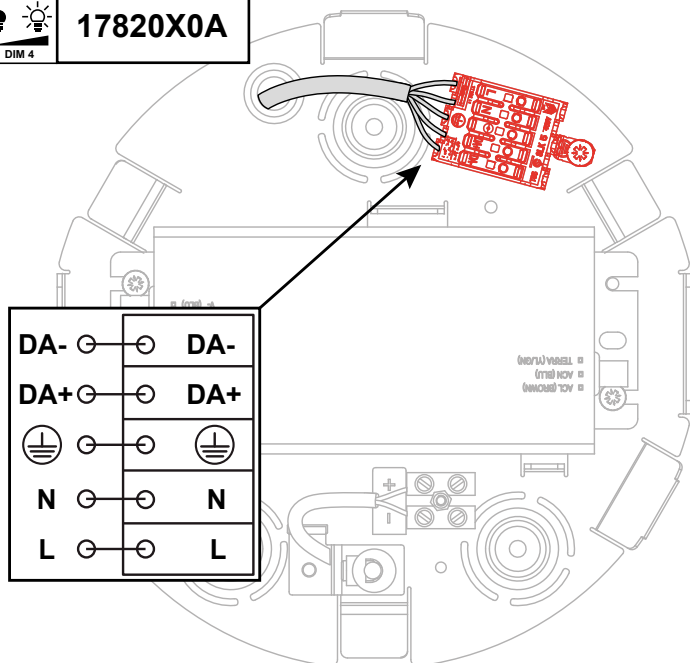

6b



17820X0A

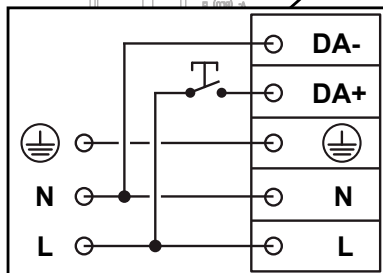

7a



17820X0APP

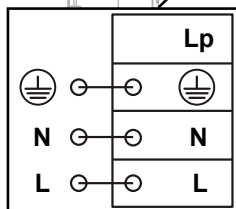

7b



17820X0APP

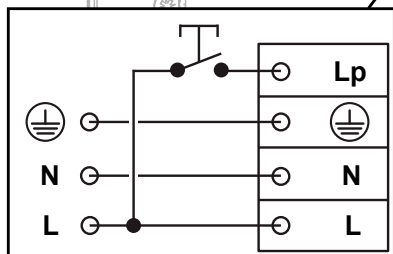

8

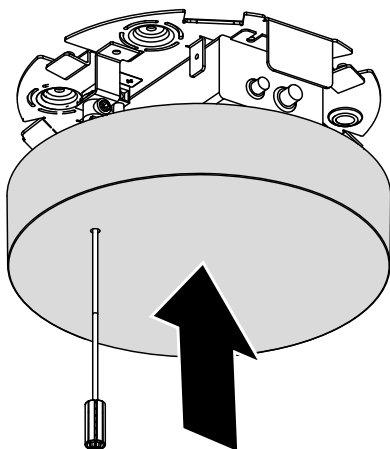

9

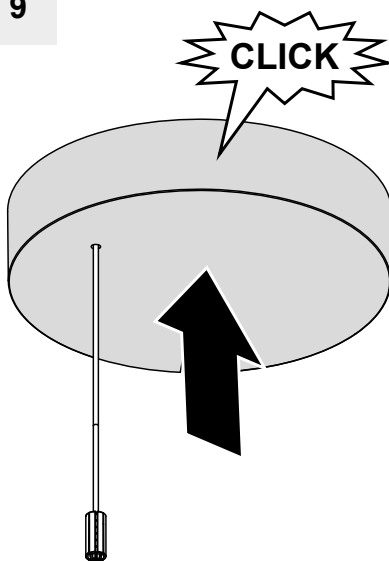

10

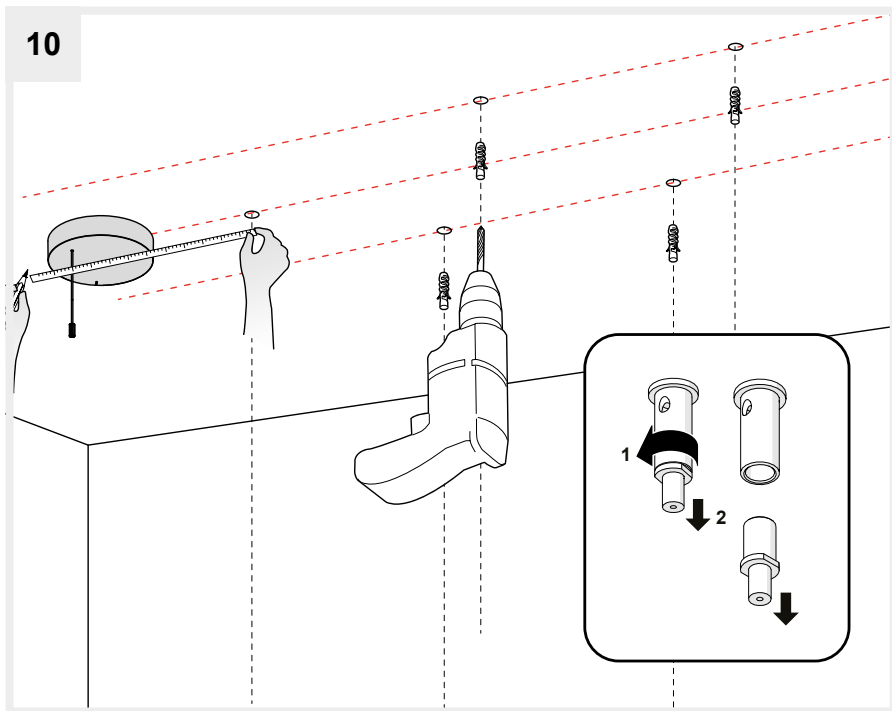

11

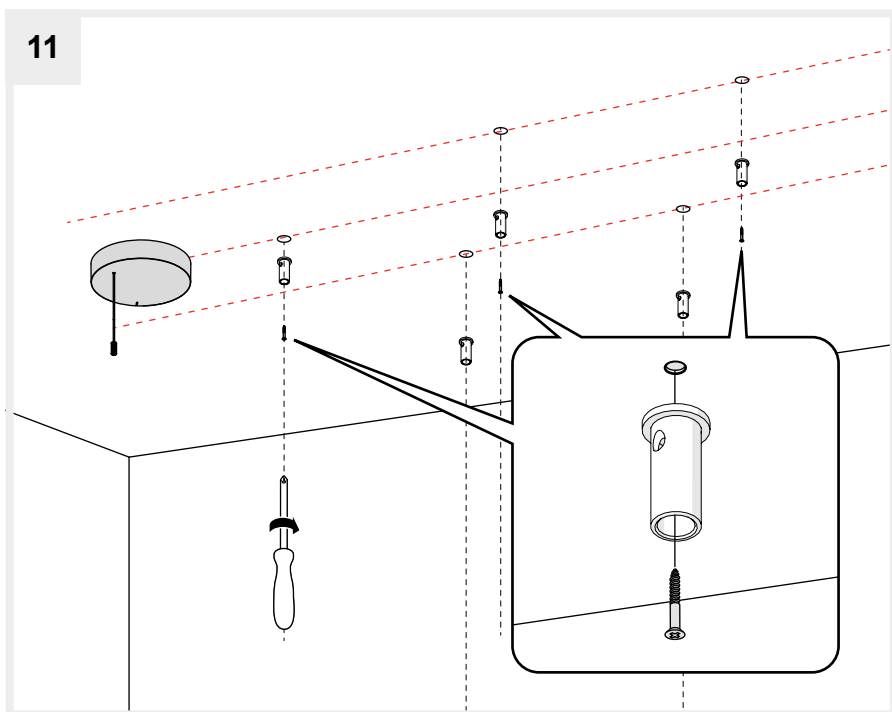

12

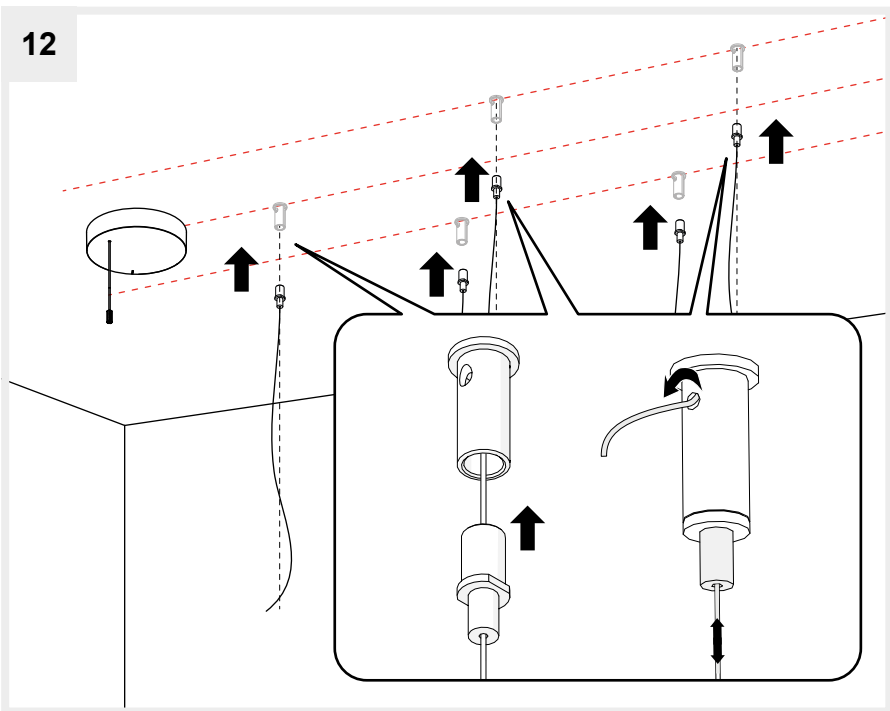

13

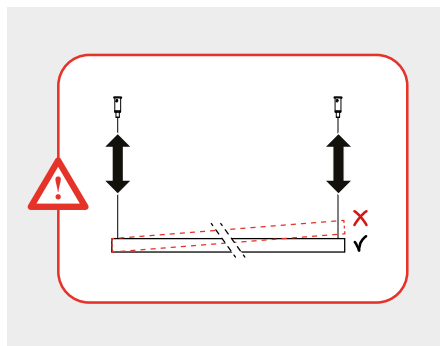
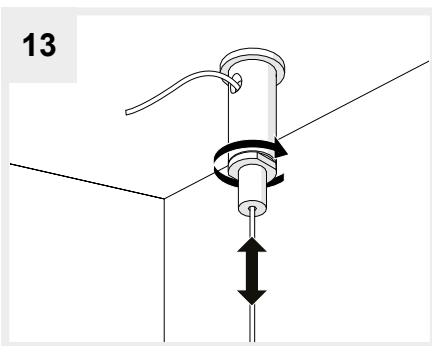

14

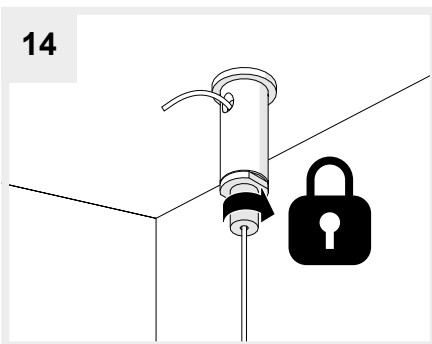

15

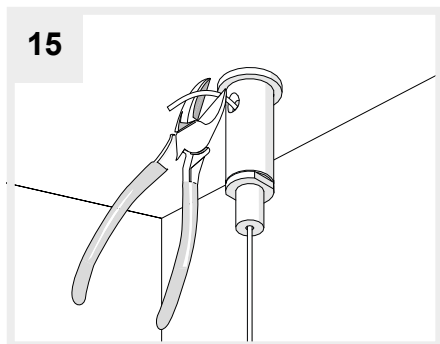

16

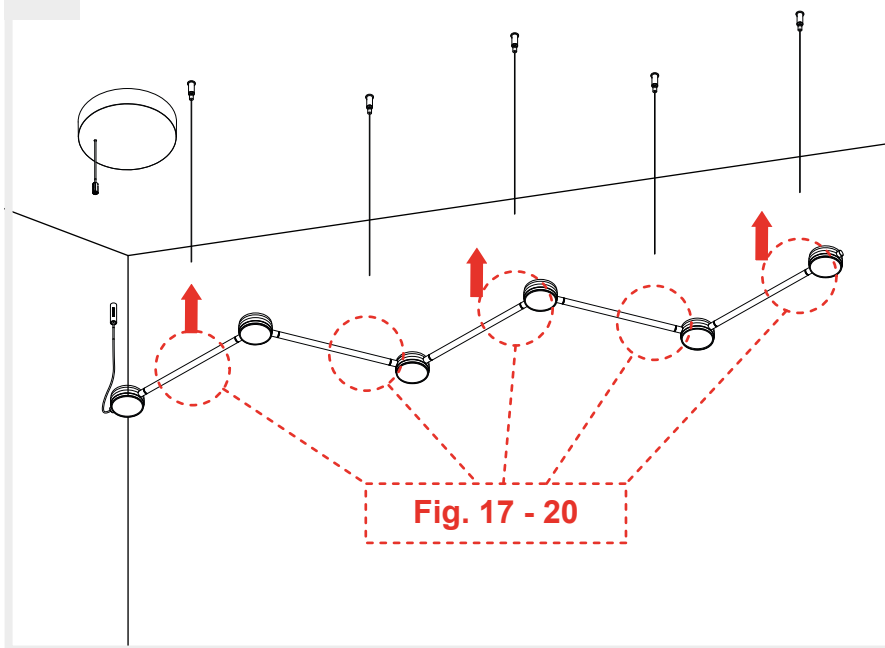

17

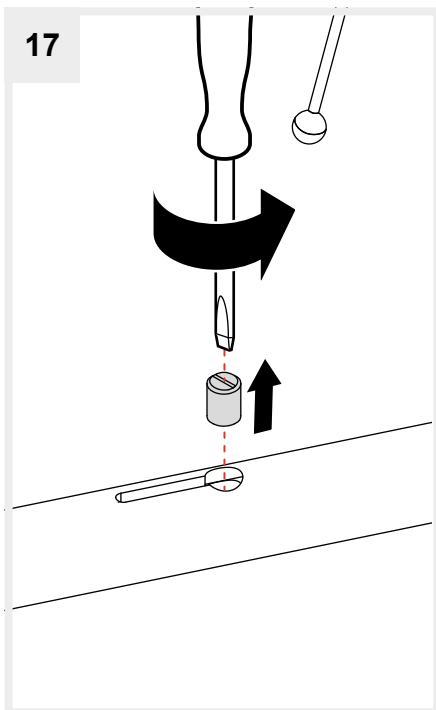

18

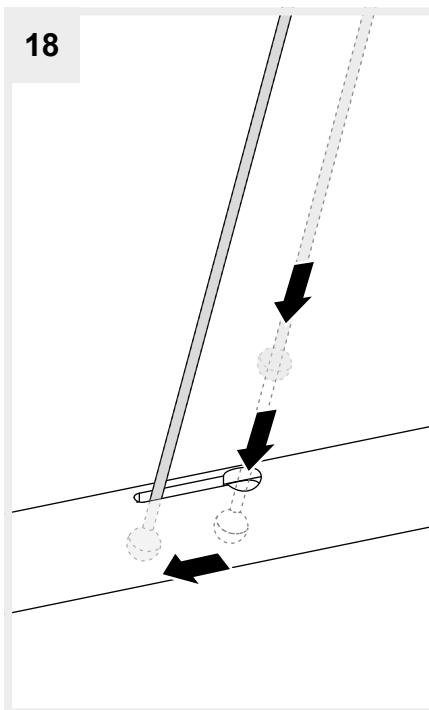

19

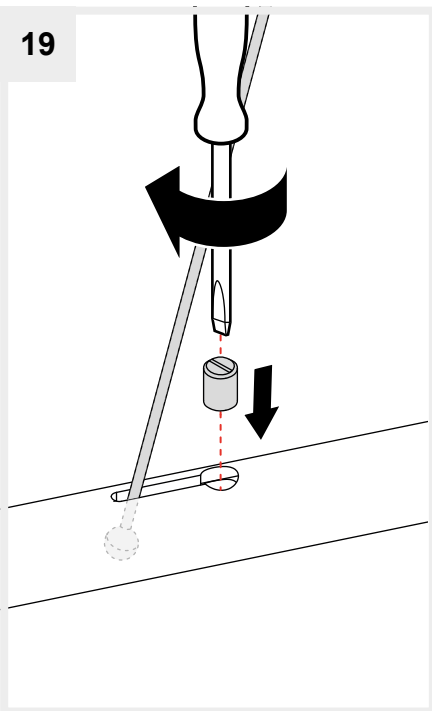

20

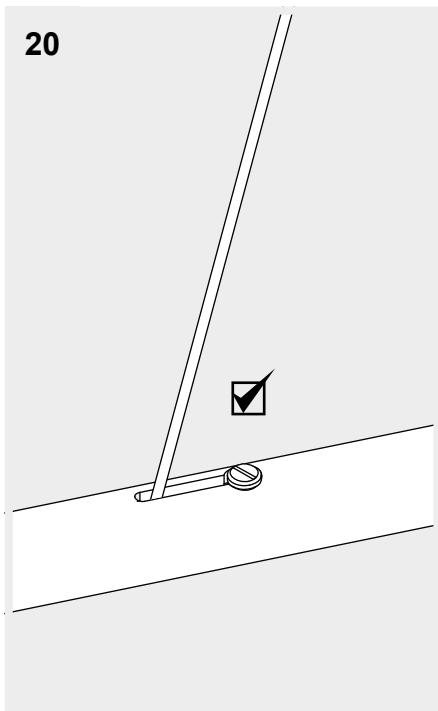

i

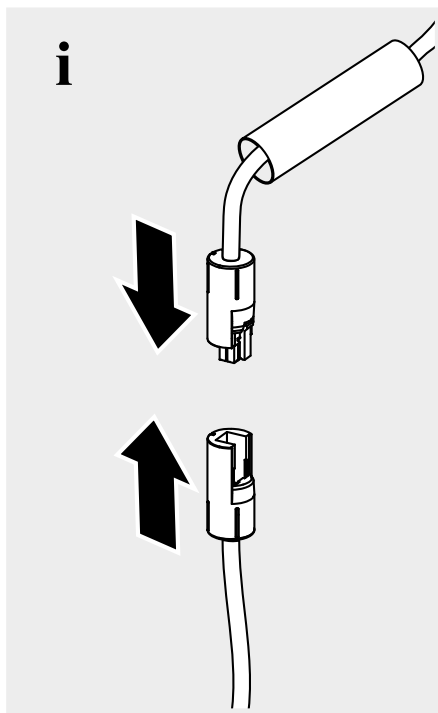

21

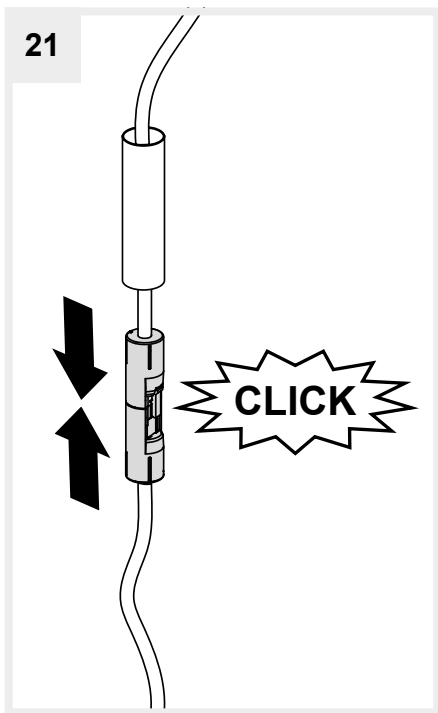

22

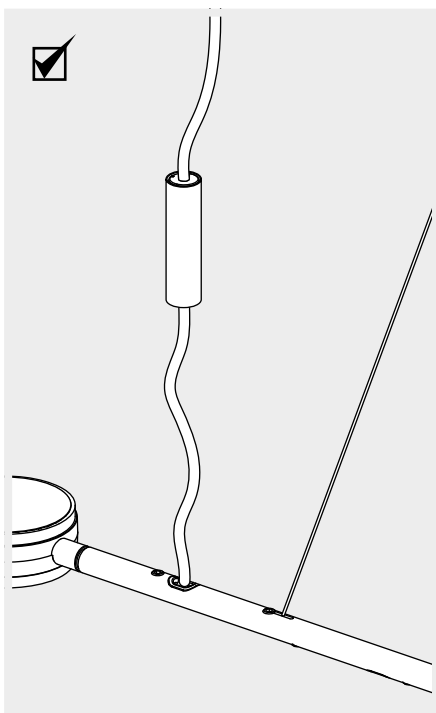
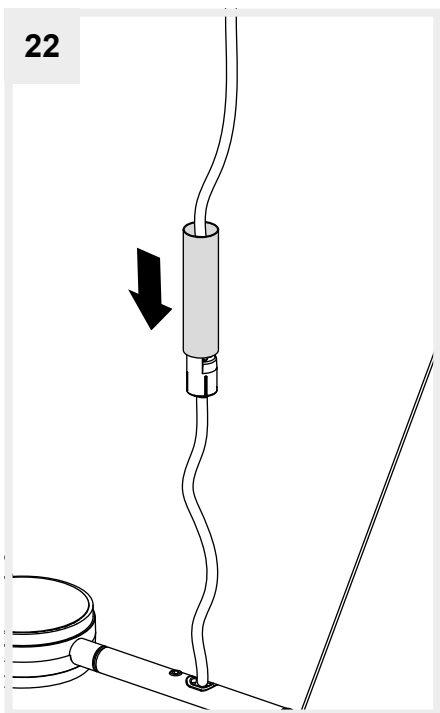

23

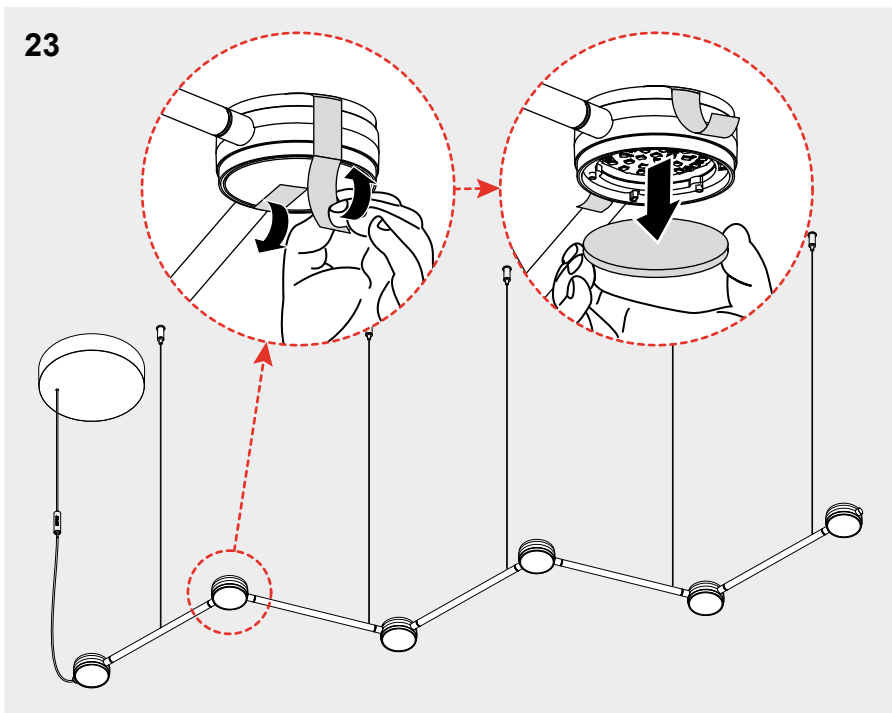

24

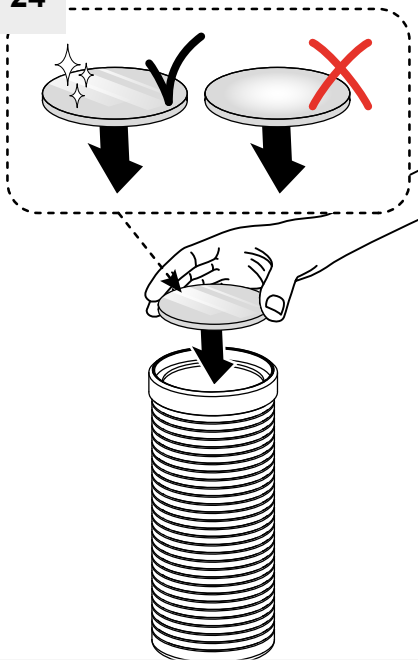

25



26

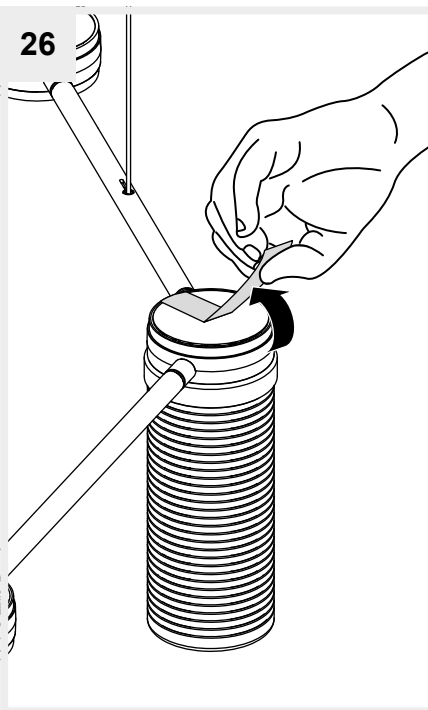

27

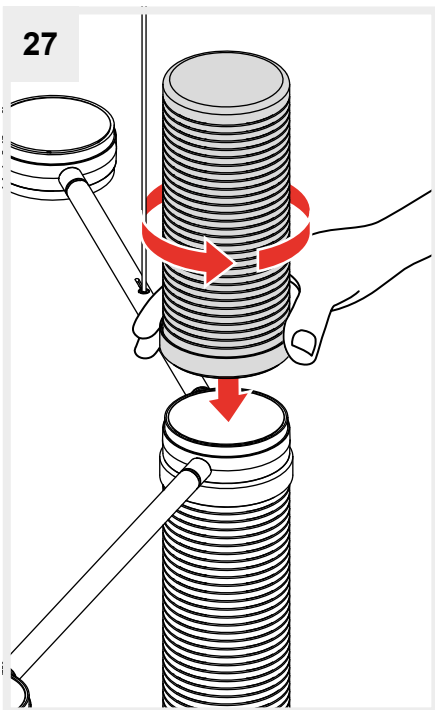

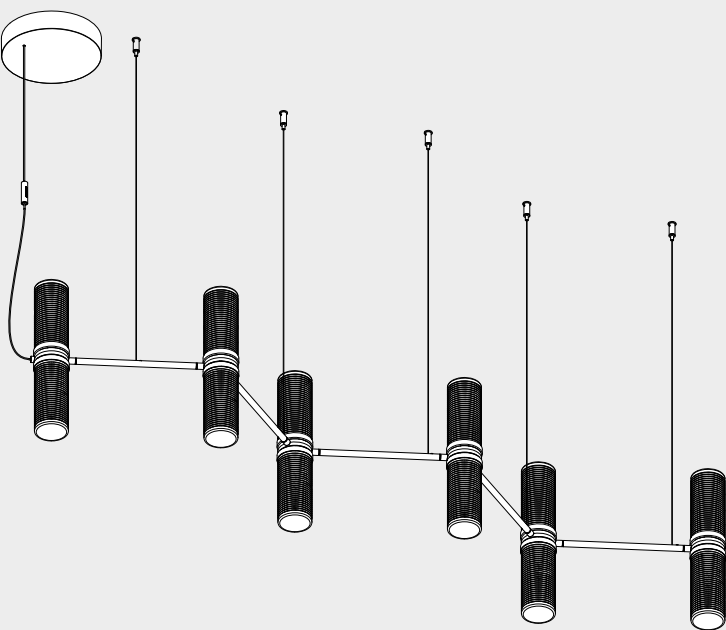
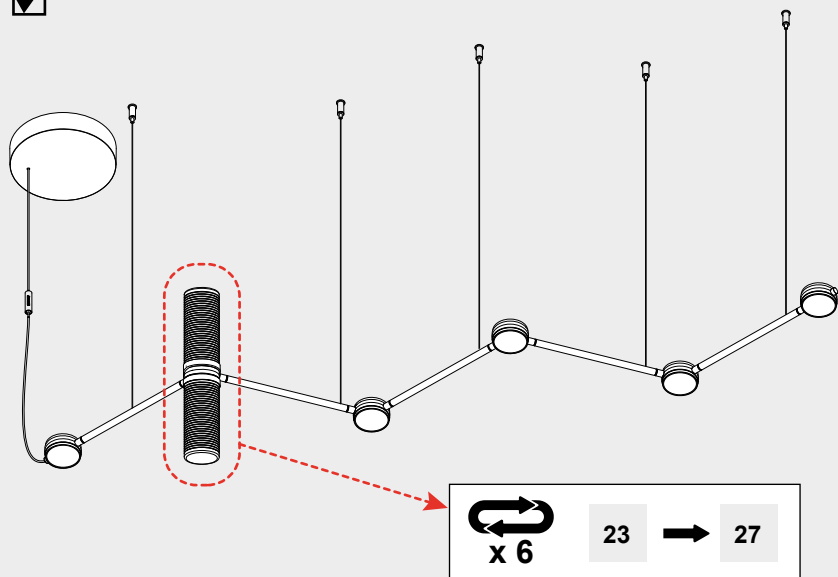

Artemide®



Artemide

via Bergamo, 18
20006 Pregnana M.se (MI)
ITALIA

tel. +39 02 935 181
fax +39 02 935 90 254
fax +39 02 935 90 496

www.artemide.com

VAT IT00846890150

cod. Y513002012E